

Peguis Promenade

Reenders Drive & Rougeau Road
Winnipeg, Manitoba

East Winnipeg's Exciting New Development Adjacent to Kildonan Place and Costco



**NORTHEAST
WINNIPEG**



**64,587
HOUSEHOLDS**
Based on Trade Area (2025)



**147,937
DAYTIME
POPULATION**
Based on Trade Area (2025)



**24,800
VEHICLES
PER DAY**
Reenders Dr. (2024)



**500+ NEW
MULTIFAMILY
UNITS ON-SITE**

Peguis Promenade

Reenders Drive & Rougeau Road
Winnipeg, Manitoba

Mixed-Use Development, Adjacent to Kildonan Place and Costco

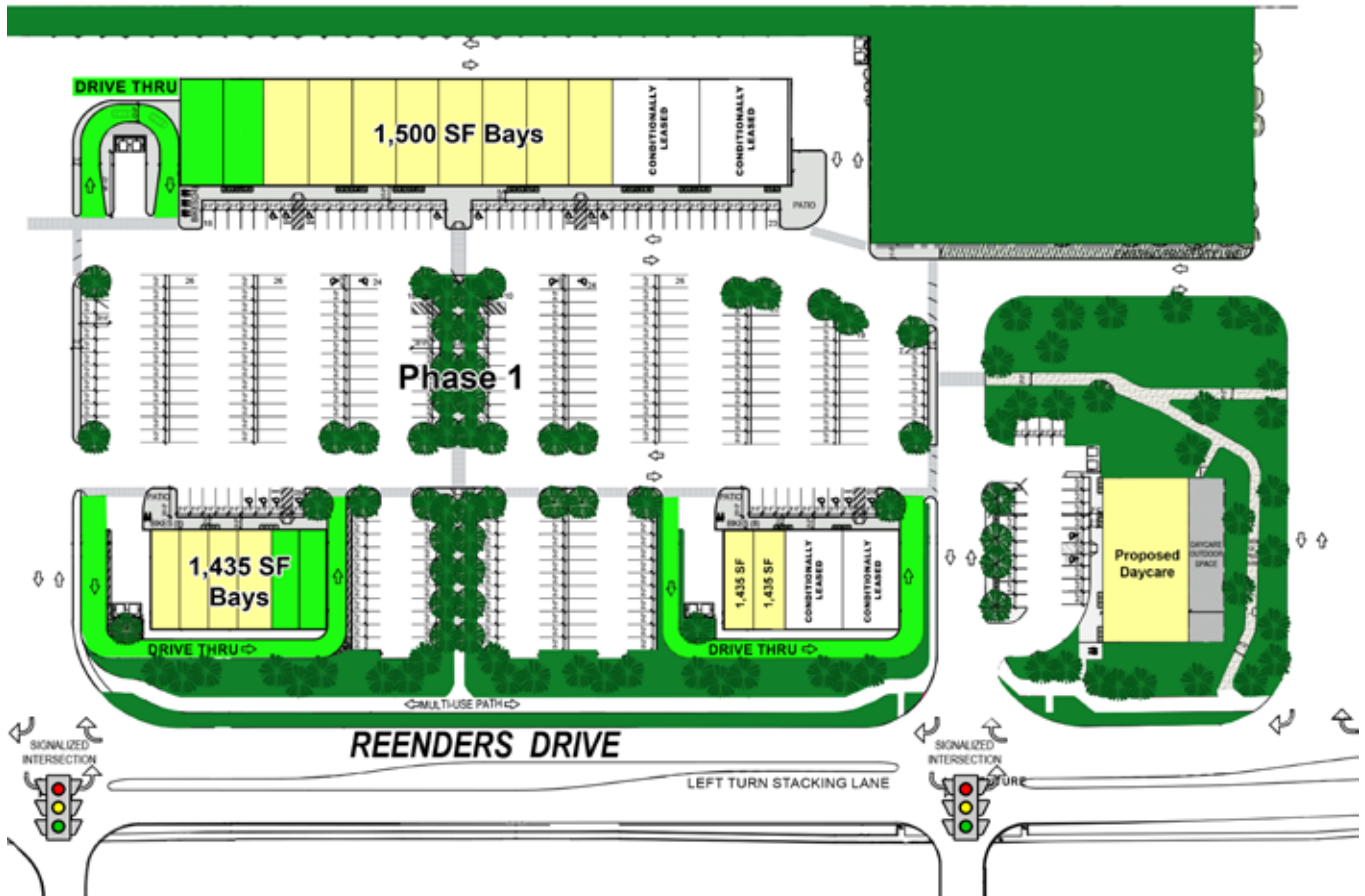

IN THE HEART OF EAST WINNIPEG'S LARGEST SHOPPING DESTINATION

Situated in the centre of a **dominant shopping hub** serving east Winnipeg. Peguis Promenade is a new mixed-use development featuring luxury rental apartments to compliment new service and retail.



Accommodate all sizes and uses
Prominent drive-thru opportunities and major pylon signage proposed



Growing Residential Area
Fast growing residential area with thousands of new homes planned. 7,000+ new households in last decade



Infrastructure Improvements
Multi-million investment including the extension and widening of Reenders Drive & Peguis Street



Excellent Public Transportation
There are 10 transit routes in the immediate vicinity, connecting to all areas of the city

204.474.2000

Shindico

Peguis Promenade

Reenders Drive & Rougeau Road
Winnipeg, Manitoba

Mixed-Use Development, Adjacent to Kildonan Place and Costco



YOUR FLAGSHIP LOCATION IN A THRIVING RETAIL & RESIDENTIAL CORRIDOR

- Adjacent to Canadian Tire (major expansion underway) and Costco (with expanded parking), and across the street from Kildonan Place Shopping Centre, northeast Winnipeg's regional shopping centre with over 100 shops, food court and theatre.
- Over **500 new purpose-built rental units** are planned for the development.
- Regional attractions include Cineplex Junxion, Club Regent Casino (1,642,500 visitors annually), the Regent Avenue Auto Strip, Home Depot, Walmart Supercentre, Real Canadian Superstore and Rona+.
- **Large Daytime Population** with significant employment lands nearby including:
 - Canada Revenue Agency's Winnipeg Taxation Centre (3,000+ employees).
 - St. Boniface Industrial Park, to the south, which includes approximately 15,000 employees from companies such as New Flyer Industries, Palliser Furniture, Richlu Manufacturing, Bison Transport, Parmalat, and BeeMaid.
- **Ready for tenant occupancy Spring 2027.**



Peguis Promenade

Reenders Drive & Rougeau Road
Winnipeg, Manitoba

Mixed-Use Development, Adjacent to Kildonan Place and Costco

TRADE AREA DEMOGRAPHICS



164,186
Population



38.3
Median Age



64,587
Households



CA\$87,266
Median Income

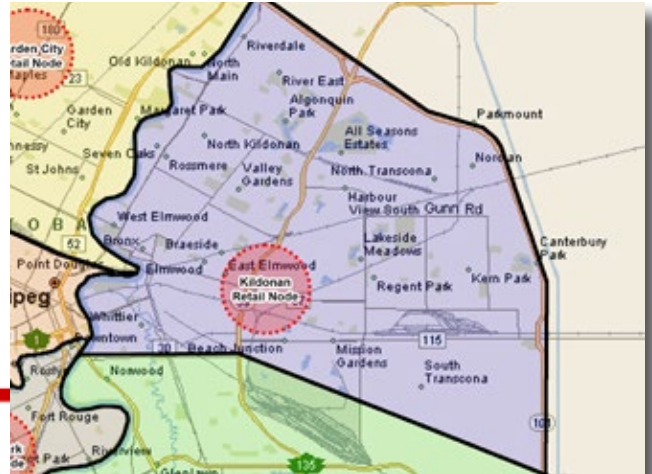

Population and Household Counts

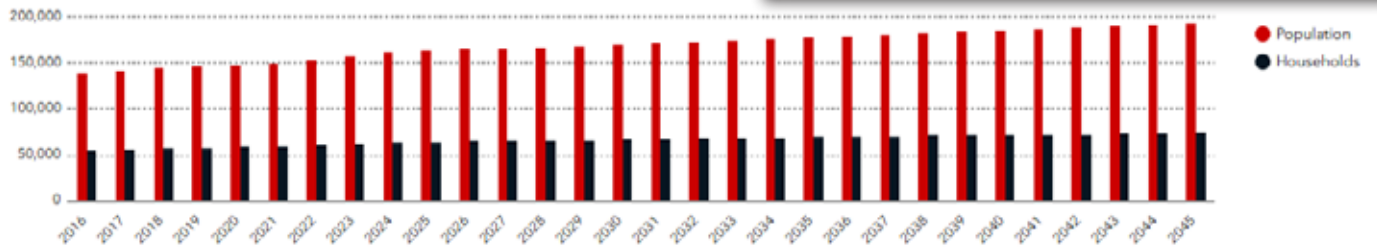

Population and Household Percent Changes

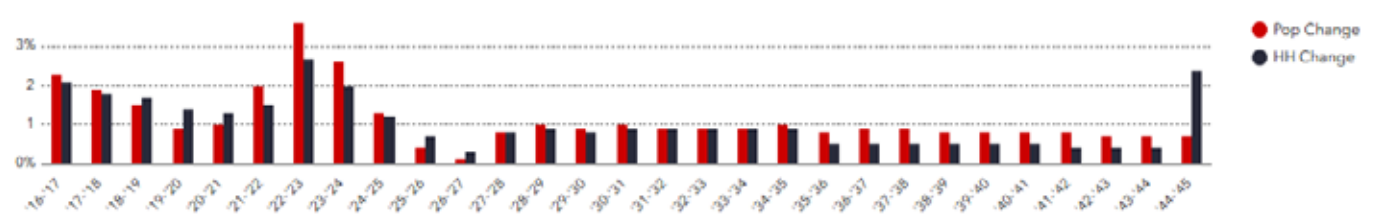

9+%
Population growth
in the last 5 years

10+%
Growth in
Total Households
in the last 5 years

50%
Daytime Population
is at work

Environics Analytics ©2025

Peguis Promenade

Reenders Drive & Rougeau Road
Winnipeg, Manitoba

Mixed-Use Development, Adjacent to Kildonan Place and Costco

ONE OF THE **FASTEST** GROWING RESIDENTIAL AREAS IN WINNIPEG WITH **THOUSANDS** OF NEW HOMES



Harbourview South
920 Homes

New Residential

Kildonan Green
700 Homes

Crocus Meadows
325 Homes
2 Multi-Family Sites

Devonshire Park
2,800 Homes

Starlite Village
Single &
Multi-Family Homes

Kildonan Meadows Park
500 Homes

Devonshire Village
209 Homes
10 Multi-Family Sites

Park City Commons
750 Multi-Family Units

PEGUIS PROMENADE

Peguis Promenade

Reenders Drive & Rougeau Road
Winnipeg, Manitoba

Mixed-Use Development, Adjacent to Kildonan Place and Costco



FOR MORE INFORMATION, PLEASE CONTACT:

Michael Stronger*

*SHINDICO REALTY, MICHAEL STRONGER and SHINDICO REALTY are affiliated Brokers

P (204) 928-8237
C (204) 793-3448
mstronger@shindico.com

Dino Alevizos*

*Services provided by Dino Alevizos Personal Real Estate Corporation

P (204) 928-8209
C (204) 781-9717
dalevizos@shindico.com

Shindico Realty Inc.

200-1355 Taylor Avenue
Winnipeg, Manitoba R3M 3Y9
P (204) 474-2000
inquire@shindico.com
www.shindico.com



Shindico is dedicated to the protection of the environment and the communities that we are a part of.

The accuracy of the information set out herein has not been confirmed, and Shindico Realty Inc. and its affiliates make no representations or warranties as to the accuracy of the information and assumes no responsibility for errors or omissions. The recipient is responsible to verify the accuracy of any information and bears all risk related to any inaccuracies.032526