

# FOR LEASE

Coming to Market - 24,000 SF - 100,000 SF Multi-Tenant Industrial

**AVAAL Business Park** - 148 & 160 Wheatfield Rd & 64 Bryan Bay, RM of Rosser, MB

## INDUSTRIAL STRENGTH



*Concept Rendering*



**MINUTES FROM  
INTERNATIONAL  
AIRPORT**



**COMPOUND  
SPACE**



**FULLY  
SERVICED**



**CLOSE TO  
TRANSPORTATION  
ROUTES**

[www.shindico.com](http://www.shindico.com)

**AVAAL** *Shindico*

# FOR LEASE

AVAAL Business Park - 148 & 160 Wheatfield Rd & 64 Bryan Bay, RM of Rosser, MB

## SITE PLAN

**AVAAL  
BUSINESS PARK**

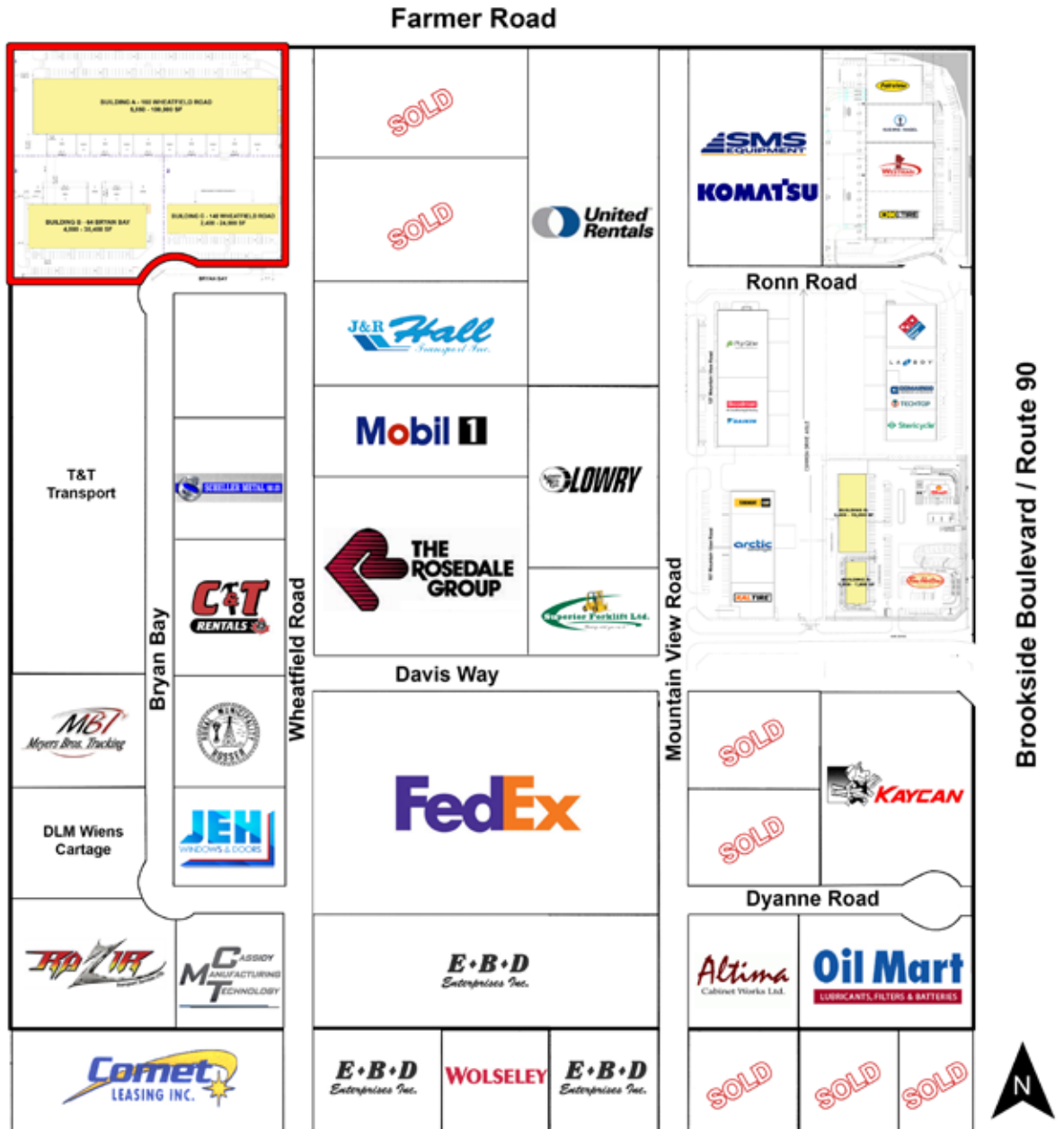

# FOR LEASE

**AVAAL Business Park - 148 & 160 Wheatfield Rd & 64 Bryan Bay, RM of Rosser, MB**

## PROPERTY SUMMARY

### Available:

160 Wheatfield Road - 100,000 +/- SF  
64 Bryan Bay - 38,400 +/- SF  
148 Wheatfield Road - 24,000 +/- SF

Lease Rate TBD

CAM (est. 2021) \$3.50/SF  
plus management fee

Proposed Bay Sizes 2,000 to 5,830 +/- SF

Land Size All Parcels - 10.23 +/- Acres

Ceiling Height 24' - 32'

Loading Dock & Grade

### Utilities:

- Separately Metered Electricity & Natural Gas
- Municipal Service for Water & Sanitation

Parking Ample Staff & Tenant Parking

Zoning I2 - Industrial

## AVAAL BUSINESS PARK HIGHLIGHTS

- Brand new state-of-the-art multi-tenant industrial building with build-to-suit options available.
- Fully sprinklered.
- Professionally managed.
- Fully serviced (asphalt roads, water, sewer, hydro, gas, high speed internet/phone).
- Heavy duty gravel in truck maneuvering areas.
- Farmer Road to Wheatfield Road will be paved in 2021.
- Commercial duty asphalt paving in automobile parking areas.
- Tenant fit-ups slated for Q1 2022.
- Strategically in the R.M. of Rosser within CentrePort Canada - North America's new 20,000-acre inland port.
- Located adjacent to Brookside Business Park with exposure to Farmer Road, Wheatfield Road & Bryan Bay.
- No City of Winnipeg business taxes.
- Excellent access to Brookside Boulevard (Route 90) & CentrePort Canada Way, in close proximity to the Winnipeg James Armstrong Richardson International Airport.



*Concept Rendering*

# FOR LEASE

AVAAL Business Park - 148 & 160 Wheatfield Rd & 64 Bryan Bay, RM of Rosser, MB

## OVERALL SITE PLAN

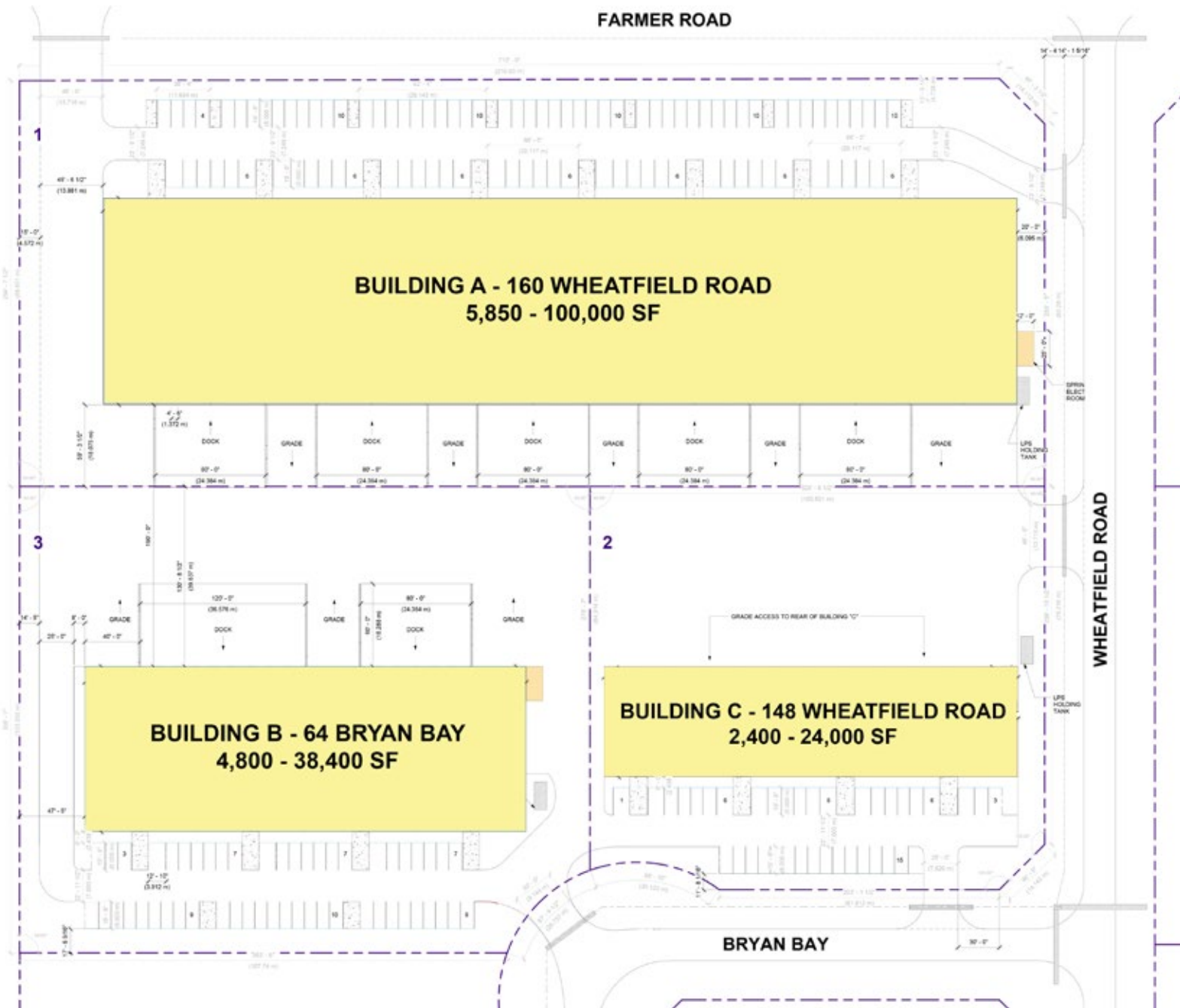

INDUSTRIAL STRENGTH

AVAAL<sup>TM</sup> Shindico

# FOR LEASE

AVAAL Business Park - 148 & 160 Wheatfield Rd & 64 Bryan Bay, RM of Rosser, MB

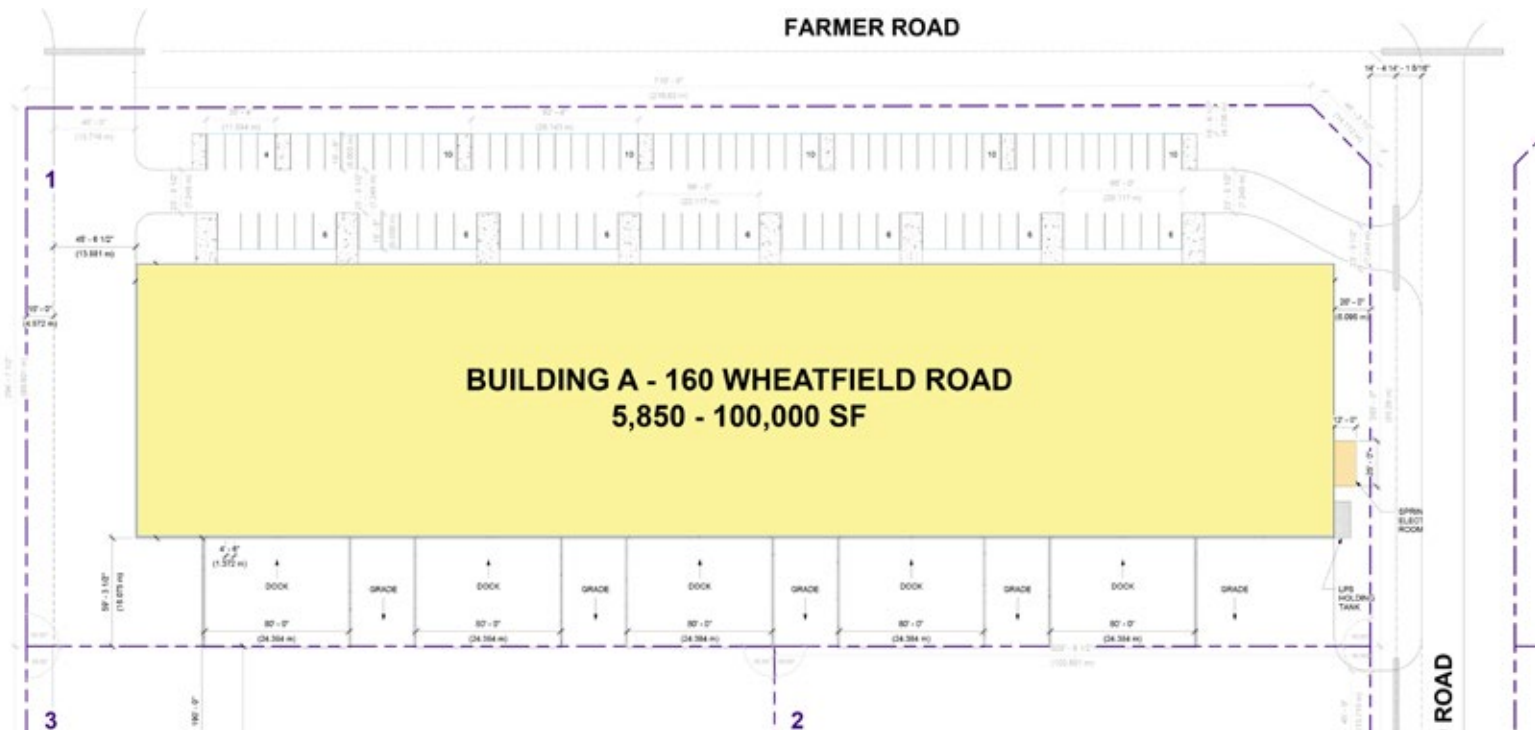

## BUILDING A - 160 WHEATFIELD ROAD SPECIFICATIONS

Building Size	100,000 +/- SF
Proposed Bay Sizes	5,850 +/- SF (39' x 150')
Ceiling Height	28' - 32' Clear
Dock Doors	Full vertical lift with dock seals Hydraulically operated dock leveler
Grade Doors	Overhead door
Floors	7" reinforced concrete floors throughout
Power	1000A, 347/600V 3-Phase
Fire Protection	ESFR sprinkler system for Class I-IV commodities and Group A plastics Code compliant fire alarm system
Paving	Heavy duty paving in truck manoeuvring areas Commercial duty asphalt paving in automotive parking areas

# FOR LEASE

AVAAL Business Park - 148 & 160 Wheatfield Rd & 64 Bryan Bay, RM of Rosser, MB

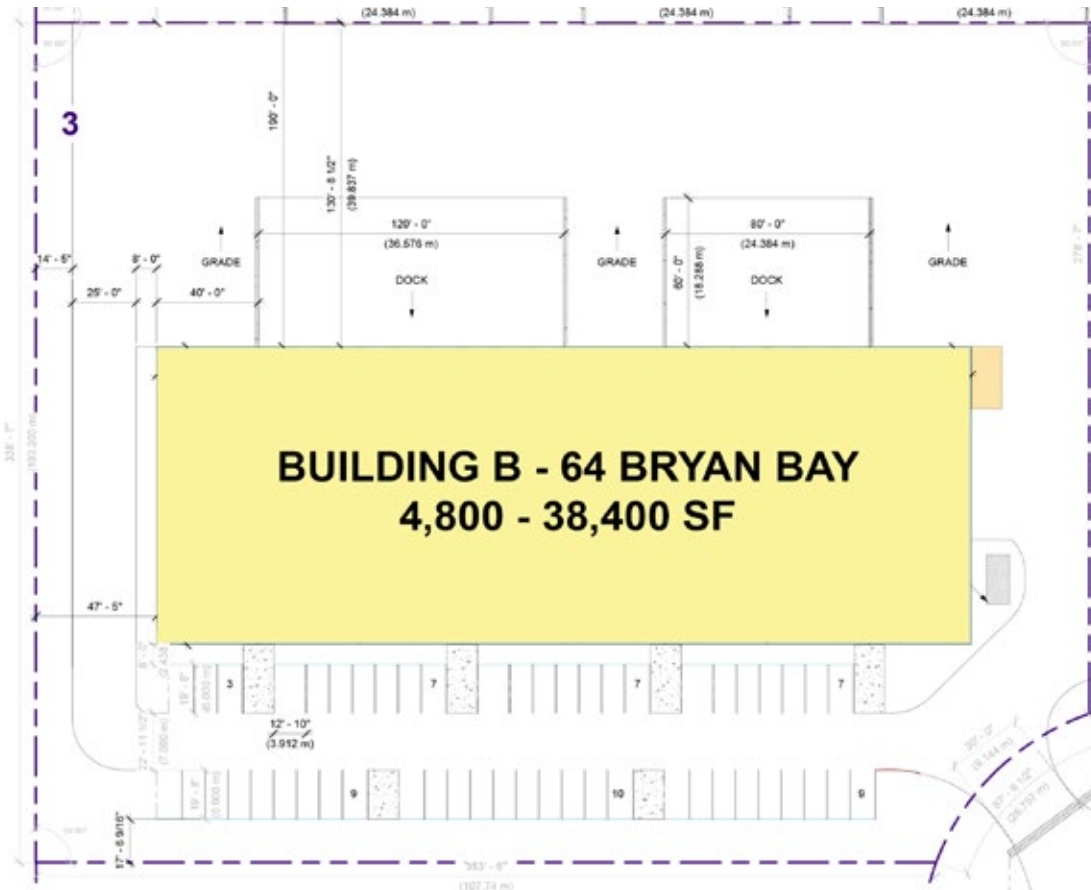

## BUILDING B - 64 BRYAN BAY SPECIFICATIONS

Building Size	38,400 +/- SF
Proposed Bay Sizes	4,800 +/- SF (40' x 110')
Ceiling Height	28' Clear
Dock Doors	Available
Grade Doors	Available
Floors	Reinforced concrete floors throughout
Warehouse Heating	Sealed combustion gas fired unit heaters
Fire Protection	ESFR sprinkler system for Class I-IV commodities and Group A plastics Code compliant fire alarm system
Paving	Heavy duty paving in truck manoeuvring areas Commercial duty asphalt paving in automotive parking areas

# FOR LEASE

AVAAL Business Park - 148 & 160 Wheatfield Rd & 64 Bryan Bay, RM of Rosser, MB

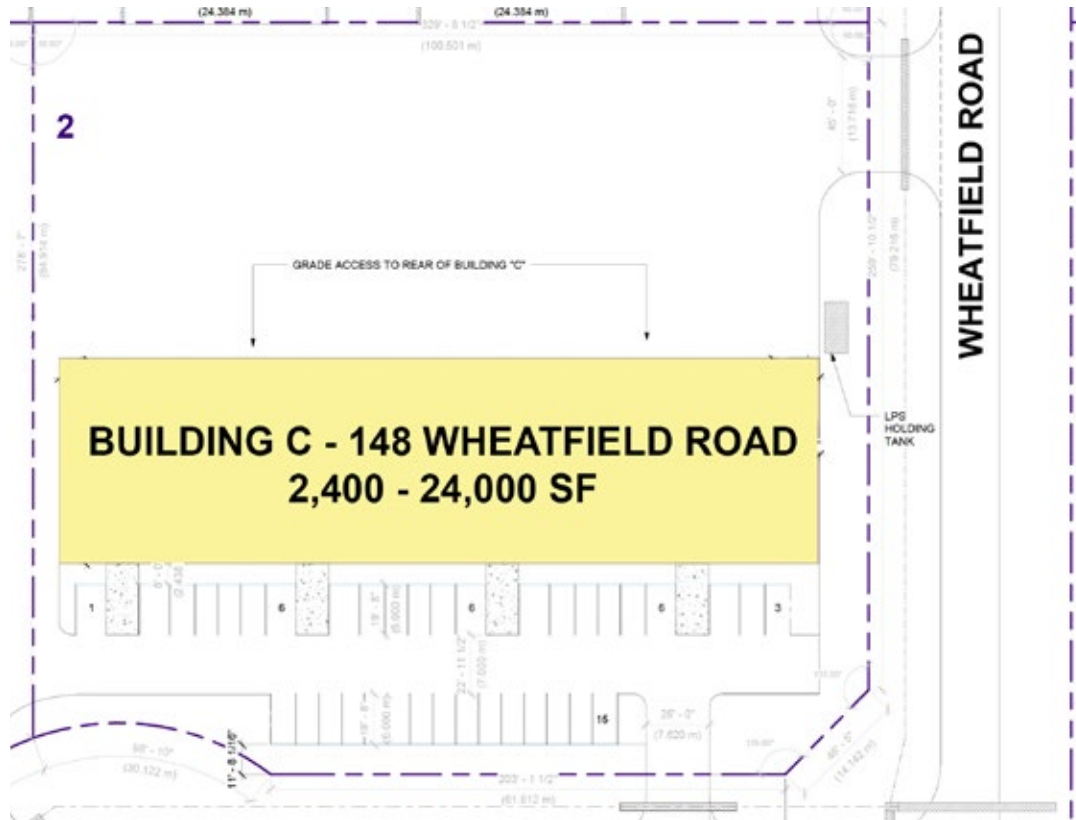

## BUILDING C - 148 WHEATFIELD ROAD SPECIFICATIONS

Building Size	24,000 +/- SF
Proposed Bay Sizes	2,000 +/- SF (25' x 80')
Frontage	Facing Bryan Bay
Ceiling Height	24' Clear
Grade Doors	1 Door Per Unit
Floors	6" reinforced concrete floors throughout
Warehouse Heating	Sealed combustion gas fired unit heaters
Fire Protection	ESFR sprinkler system for Class I-IV commodities and Group A plastics Code compliant fire alarm system
Paving	Heavy duty paving in truck manoeuvring areas Commercial duty asphalt paving in automotive parking areas

# FOR LEASE

AVAAL Business Park - 148 & 160 Wheatfield Rd & 64 Bryan Bay, RM of Rosser, MB

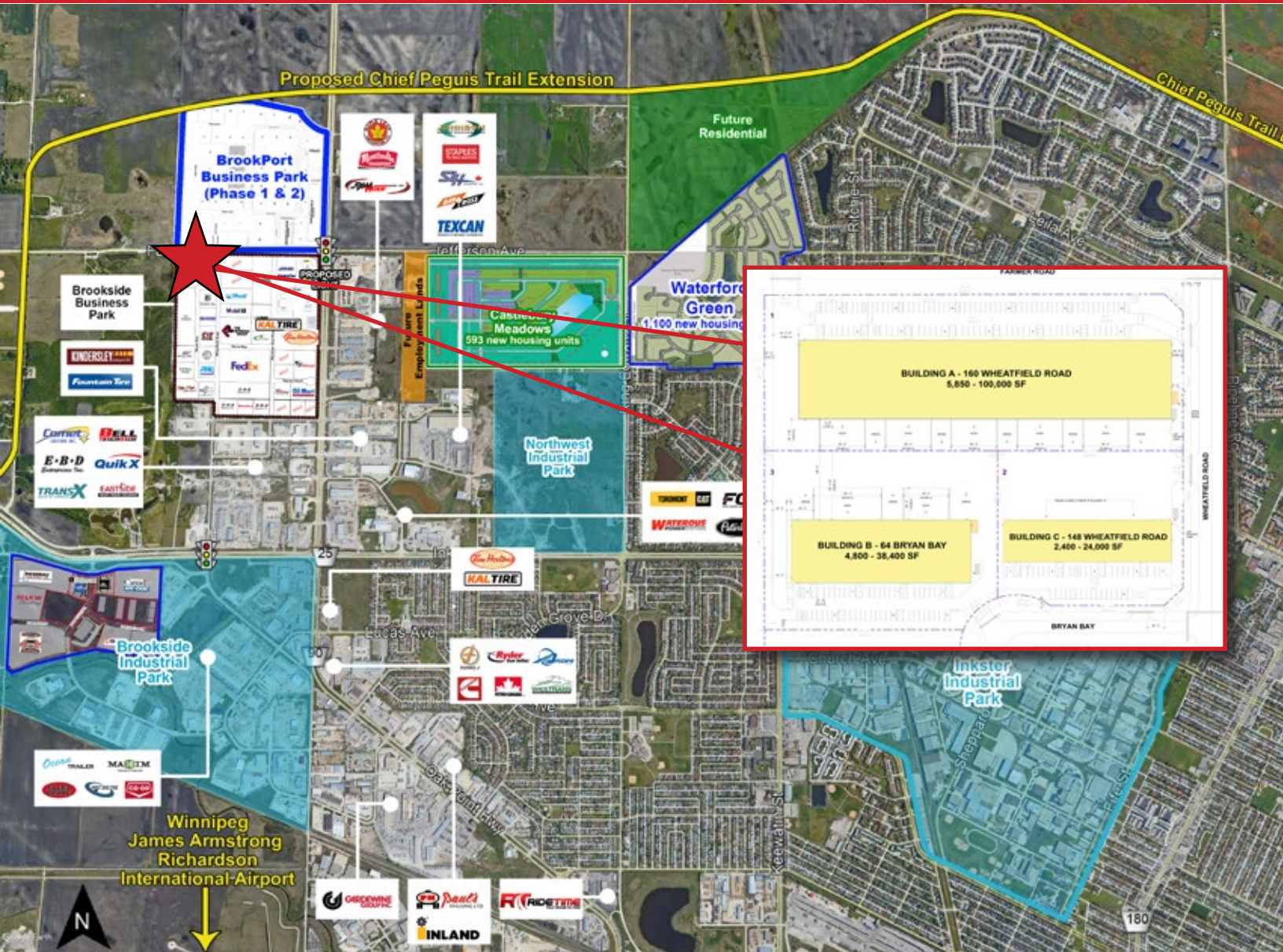

FOR MORE INFORMATION, PLEASE CONTACT:

**Robert Scaletta**  
Senior Vice President, Industrial  
P (204) 928-8242  
C (204) 223-9777  
[rscaletta@shindico.com](mailto:rscaletta@shindico.com)

**Mark Scaletta**  
Manager, Industrial  
P (204) 928-8223  
C (204) 510-3754  
[mscaletta@shindico.com](mailto:mscaletta@shindico.com)

**Shindico Realty Inc.**  
200-1355 Taylor Avenue  
Winnipeg, Manitoba R3M 3Y9  
P (204) 474-2000  
[inquire@shindico.com](mailto:inquire@shindico.com)  
[www.shindico.com](http://www.shindico.com)



**Shindico**  
Succeeding by Helping Others Succeed



*Shindico is dedicated to the protection of the environment and the communities that we are a part of.*

The accuracy of the information set out herein has not been confirmed, and Shindico Realty Inc. and its affiliates make no representations or warranties as to the accuracy of the information and assumes no responsibility for errors or omissions. The recipient is responsible to verify the accuracy of any information and bears all risk related to any inaccuracies.052021