

FOR LEASE

Highly Visible Retail / Office Space on Major Arterial Route

877 Portage Avenue & 291 Arlington Street, Winnipeg, Manitoba



6 BUS ROUTES
NEARBY



PROMINENT
SIGNAGE



60,100 VEHICLES
PER DAY
Portage Ave. (2024)



NEARBY
AMENITIES

FOR LEASE

877 Portage Avenue & 291 Arlington Street, Winnipeg, Manitoba

FLOOR PLAN

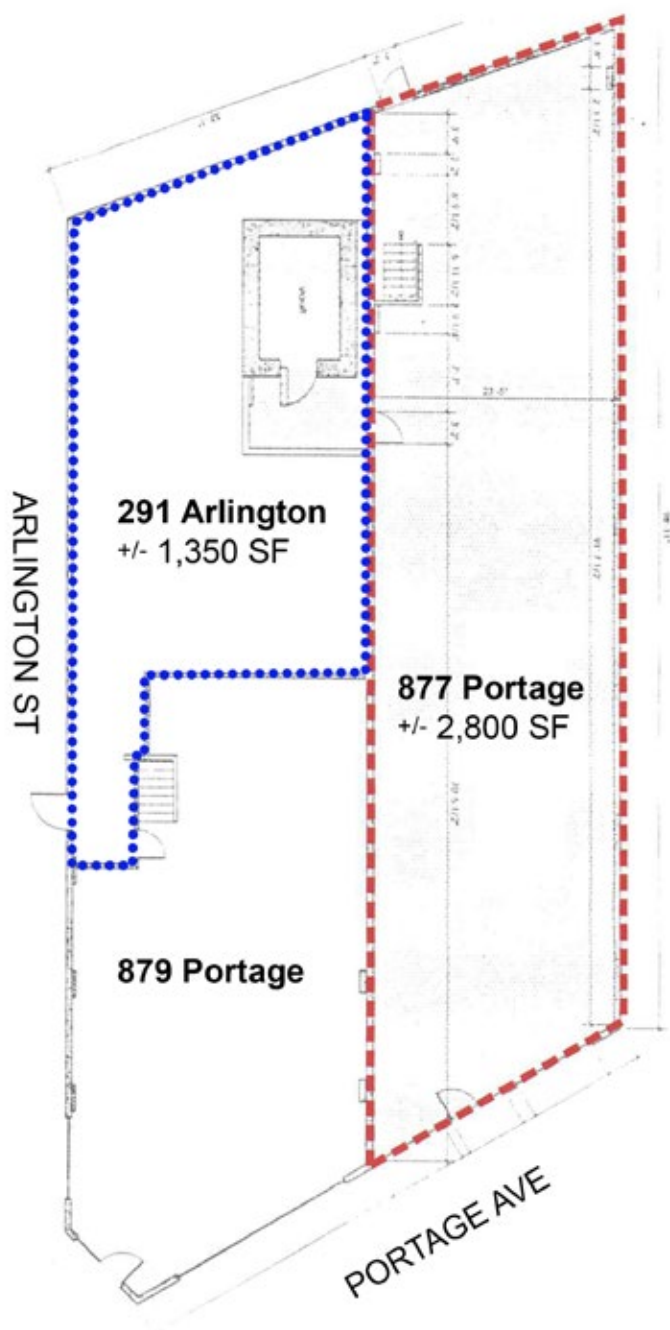

291 Arlington Street

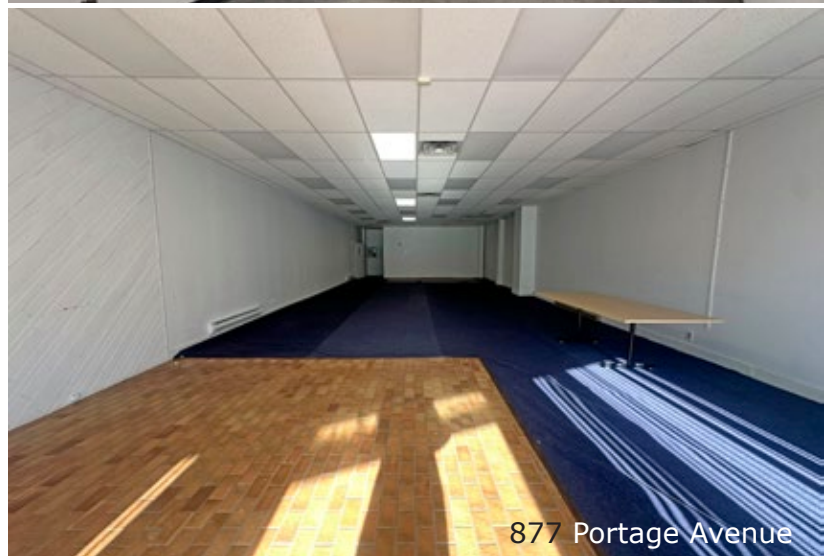

877 Portage Avenue



877 Portage Avenue

204.474.2000

Shindico

FOR LEASE

877 Portage Avenue & 291 Arlington Street, Winnipeg, Manitoba

877 PORTAGE AVENUE

| | |
|----------------------------|---------------------------|
| Available | +/- 2,800 SF |
| Net Rent | \$16.00/SF |
| Property Taxes (2025 est.) | \$4.50/SF |
| CAM* (2025 est.) | \$4.60/SF |
| Zoning | C2 - Commercial Community |

291 ARLINGTON STREET

| | |
|----------------------------|---------------------------|
| Available | +/- 1,350 SF |
| Net Rent | \$10.00/SF |
| Property Taxes (2025 est.) | \$4.50/SF |
| CAM* (2025 est.) | \$4.60/SF |
| Zoning | C2 - Commercial Community |

*plus management fee

LOCATION

- Highly visible corner building along Portage Avenue, one of the city's busiest transportation corridors.
- Excellent visibility with approximately 60,100 vehicles per day on Portage Avenue.
City of Winnipeg Public Works Department 2024
- Prominent signage opportunities.
- Strong transit connectivity (6 routes) and walkability (walkscore 90 - walker's paradise).
- Surrounded by restaurants, amenities, and services.
- Located just minutes from Winnipeg's Central Business District.
- Adjacent to Vimy Ridge Park.



DEMOGRAPHICS

| | 1 km. Radius | 3 km. Radius | 5 km. Radius |
|-----------------------|-----------------|-----------------|-----------------|
| Total Population | 20,454 | 123,121 | 242,163 |
| Daytime Population | 20,197 | 214,497 | 348,756 |
| Households | 8,781 | 56,547 | 105,426 |
| Median Age | 35.8 | 36.3 | 37.3 |
| Avg. Household Income | \$82,069 | \$91,334 | \$96,661 |

Environics Analytics ©2025

FOR LEASE

877 Portage Avenue & 291 Arlington Street, Winnipeg, Manitoba



FOR MORE INFORMATION, PLEASE CONTACT:

Kalvine Zinzombe
Leasing and Sales Associate
P (204) 306-9183
C (204) 805-1053
kzinzombe@shindico.com

Shindico Realty Inc.
200-1355 Taylor Avenue
Winnipeg, Manitoba R3M 3Y9
P (204) 474-2000
inquire@shindico.com
www.shindico.com



Shindico
SUCCEEDING BY HELPING OTHERS SUCCEED



Shindico is dedicated to the protection of the environment and the communities that we are a part of.

The accuracy of the information set out herein has not been confirmed, and Shindico Realty Inc. and its affiliates make no representations or warranties as to the accuracy of the information and assumes no responsibility for errors or omissions. The recipient is responsible to verify the accuracy of any information and bears all risk related to any inaccuracies. 020526