

FOR LEASE

Modern New Office Building Under Construction

60 South Landing Drive, R.M. of MacDonald, Manitoba



**GREAT
VISIBILITY**



**AMPLE
PARKING**



**AMENITIES
NEARBY**

www.shindico.com

Shindico

FOR LEASE

60 South Landing Drive, R.M. of MacDonald, Manitoba



204.474.2000

Shindico

FOR LEASE

60 South Landing Drive, R.M. of MacDonald, Manitoba

PROPERTY SUMMARY

Available 2,800 SF
(can be demised for 2 bays of 1,400 SF)

Net Rent \$17.00/SF

Additional Rent* (est.) \$5.00/SF

Land Area 1.1 acres

Zoning ML - Light Industrial

Parking Ample On-Site

*plus management fee of 5% net rent

FEATURES

- **New office building, available Early 2023.**
- Opportunity for 10 ft. overhead loading door.
- Located in R.M. of MacDonald with **no business tax!**
- Excellent visibility and access.
- Situated minutes from Winnipeg's key southwest retail trade area, Kenaston Boulevard & McGillivray Boulevard.



SITE PLAN

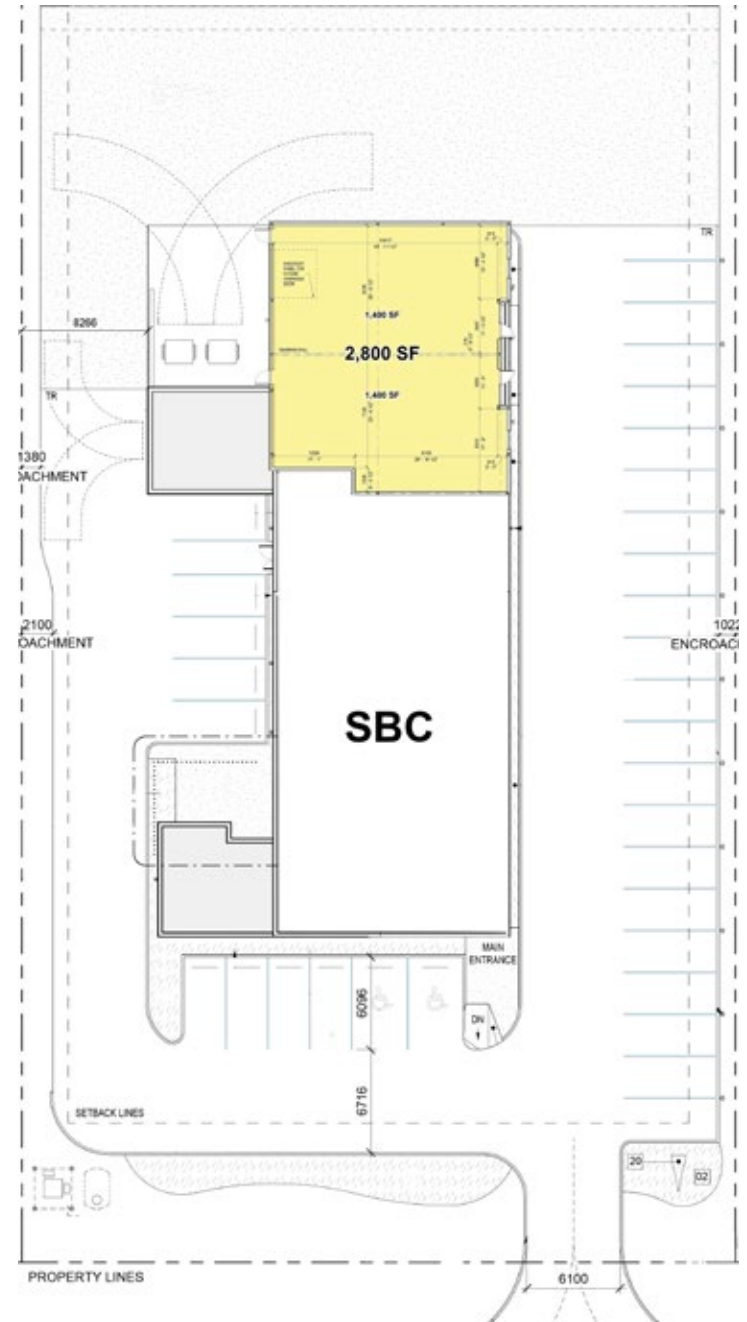

FOR LEASE

60 South Landing Drive, R.M. of MacDonald, Manitoba



FOR MORE INFORMATION, PLEASE CONTACT:

Dino Alevizos*

*Services provided by Dino Alevizos Personal Real Estate Corporation

P (204) 928-8209

C (204) 781-9717

dalevizos@shindico.com

Shindico Realty Inc.

200-1355 Taylor Avenue

Winnipeg, Manitoba R3M 3Y9

P (204) 474-2000

inquire@shindico.com

www.shindico.com

Shindico

Succeeding by Helping Others Succeed

CORFAC
INTERNATIONAL



Shindico is dedicated to the protection of the environment and the communities that we are a part of.

The accuracy of the information set out herein has not been confirmed, and Shindico Realty Inc. and its affiliates make no representations or warranties as to the accuracy of the information and assumes no responsibility for errors or omissions. The recipient is responsible to verify the accuracy of any information and bears all risk related to any inaccuracies.053122